



DESCRIPTION

Vertical structure in aluminium with Brushed Dark Bronze finishing.
Decorative vertical elements in brass, Polished or with Brushed Dark Bronze finishing, shaped like bamboo canes through handcrafted hot working metal process.
Base and shelves in wood veneered in essence from the collection.

DIMENSIONS

BOOKCASE E.TAX.541.A

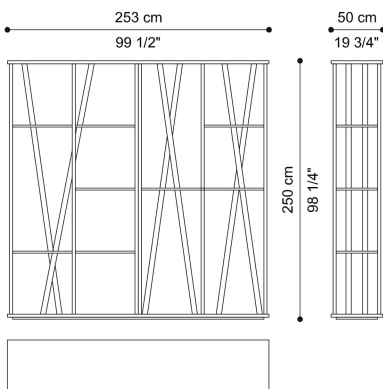

L 253 D 50 H 250 CM

STRUCTURE

METAL



Metal Brushed Dark
Bronze

BASE/SHELVES/TOP

WOOD



Carbalho Veneered
Dyed Dark Wengé -
Matt

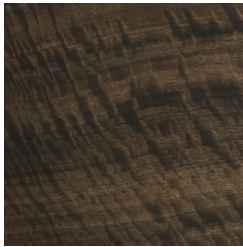

Smoked Eucalyptus
Frisé Veneered -
Semi-Glossy

DECORATIVE ELEMENTS

METAL



Metal Brushed Dark
Bronze



Polished Brass